

GENGUARD™ II SERIES

Tough to the core™

GenGuard™ II Plus 14

GenGuard™ II 16

GenGuard™ II 18

GenGuard™ II 20



The **GenGuard II Series** is a steel stiffened door with interlocking stiffeners that are spot welded to each door skin. The specially designed interlocking steel stiffener increases door rigidity and eliminates the rattling noise effect commonly associated with spot welded steel stiffened doors. Steel stiffeners are securely spot welded to door skins at 6" o.c. All voids between stiffeners are filled with fiberglass or rockwool insulation. Standard doors are 1 ¾ in. (45 mm) thick and are available in 14, 16, 18, and 20 gauge galvanized steel. The GenGuard II Series is also available in G90 galvanized steel.

General Specifications

- Door faces are flush and free of any joints, weld or seams.
- Steel stiffeners are spot welded to door skins at 6" o.c.
- Longitudinal door edges are interlocked with mechanical seam (seamless edge optional).
- Door edges are beveled 1/8" (3 mm) in 2" (50 mm).
- Door hinge reinforcements are prepared for standard weight 4 1/2" x 4 1/2" (114 mm x 114 mm) hinges which can easily be converted to accommodate heavy weight hinges.

Door Construction

- A Door face sheet (galvannealed or G90 galvanized steel).
- B Core (fiberglass or rockwool).
- C 20 gauge steel stiffeners spot welded to door skins at 6" o.c.
- D 10 gauge high frequency dual purpose hinge reinforcement with return bend for added strength. Can easily be converted to accommodate heavy weight hinges.
- E 18 gauge inverted top channel projection welded to door skins and tack welded at each corner for extra rigidity.
- F 18 gauge door closer reinforcement box.
- G 18 gauge inverted bottom channel projection welded to door skins and tack welded at each corner for extra rigidity.

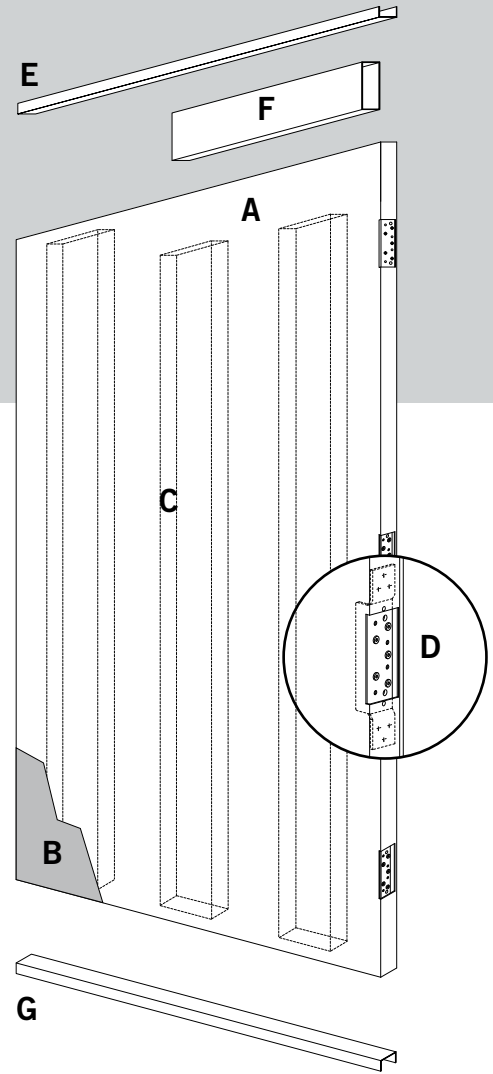

Standard Lock Preparations

161 cylindrical lock assembly reinforcement with added barrel support projection welded to door edge, in accordance with ANSI A115.2 requirements.

86 edge mortise lock preparation reinforcement box with integrated lock support, in accordance with ANSI A115.1 requirements.

Rim panic reinforcement box for surface mounted exit device application.

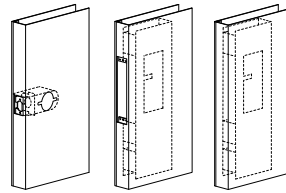

Available Cores

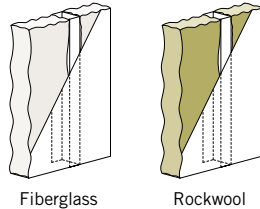

Fire Labels

GenGuard II Series fire labeled doors are approved by both Intertek Testing Services (ITS Warnock Hersey) and Underwriters Laboratories (UL) Fire Labeling Programs. Doors can be fire labeled for up to 3 hours and must be installed in an equivalent fire labeled frame with approved fire listed hardware. For fire labeling restrictions and limitations refer to Gensteel's Fire Labeling Guide for Hollow Metal Doors.



Fire Labeling Guide for Hollow Metal Doors		
Maximum Door Opening Size:		
Single Opening 4'-0" x 10'-0"		Double Door Opening 8'-0" x 10'-0"
Minimum Gauge	Rating	Allowable Glass Area
20	3 h*	Nil
20	1½ h	100 in.²
20	45 min	1296 in.²

*Maximum door size for 3 h is 4'-0" x 10'-0" for single opening and 8'-0" x 10'-0" for double door opening.

Recommended Uses	Standard Duty	Medium Duty	Heavy Duty	Extra Heavy Duty
GenGuard™ II Plus 14				X
GenGuard™ II 16			X	
GenGuard™ II 18		X	X	
GenGuard™ II 20	X	X		

Lites

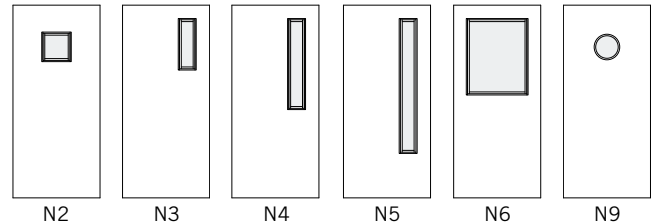

Miscellaneous

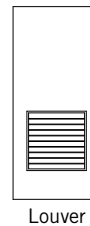

As a result of Gensteel's ongoing quest for improvement, technical specifications are subject to change without notice.

G-10 WARRANTY

Gensteel doors come with an unrivalled 10-year warranty against delamination.



Head Office & Manufacturing Plant
4950 Hickmore, St. Laurent, Quebec, Canada H4T 1K6
Toll free: 1-866-GENSTEEL (436-7833)
Telephone: (514) 733-3562 Fax: (514) 733-1932
Manufacturing Plant: Cornwall, Ontario
U.S. Manufacturing Plant: Plattsburgh, NY

www.gensteeldoors.com

™ Trademarks of Gensteel Doors

